



Pro Flow Exhaust System - Part #1042009 1989-1995 4Runner w/Coil Spring Rear Suspension

The 1042009 Pro Flow Exhaust System is designed to fit 1989 to 1995 4Runners with 22R/RE and 3VZ engines and rear coil spring suspension. This kit will not fit leaf sprung 4Runners. **This exhaust system will only work with 17.5" catalytic converter (or test pipe).**

Installation (See attached diagram):

1. Remove the stock exhaust system from the catalytic converter on back. Be careful not to damage the hangers or brackets.

2. Install the muffler into the stock hangers.
 - a. The offset side of the muffler goes towards the back of the vehicle so that the hangers also point towards the rear of the vehicle.

3. Attach the tailpipe section using a 2-bolt flange gasket. Bolt to the muffler and attach rear hanger. Do not tighten yet.

4. Check alignment and location of muffler and tailpipe. Hangers may require a slight adjustment for proper alignment.

5. Connect front pipe to back of catalytic converter using a 2-bolt flange gasket.

6. Check the clearance of your Pro Flow Exhaust System to the floor pan, chassis components, parking brake cable assembly, driveshaft, etc. Adjust system as needed.

7. Starting at the muffler, tighten bolts working towards the front and back

8. Start engine and check for exhaust leaks. Tighten flanges and clamps as needed.

****SEE DIAGRAM ON NEXT PAGE****



Part #1042009 Pro Flow Exhaust System
4-Runner w/Coil Spring Rear Suspension (1989-1995)

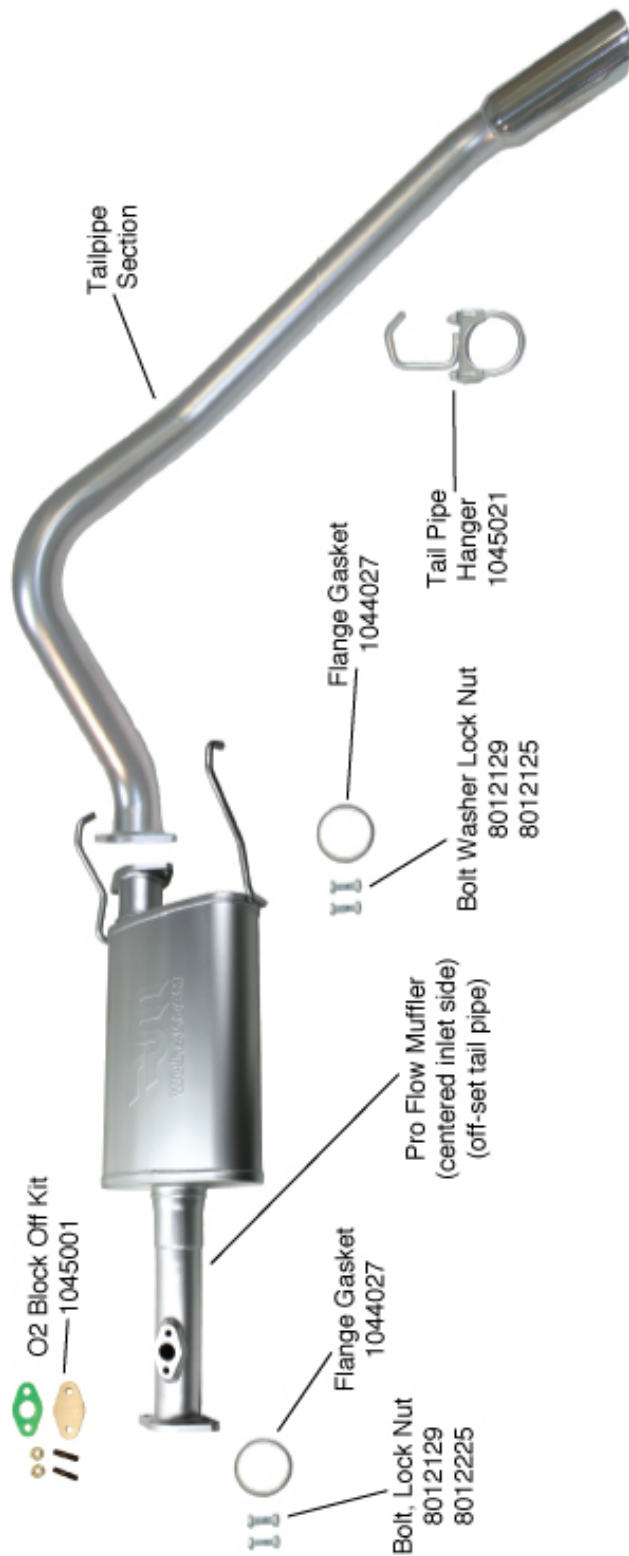

LCE Pro Flow System Includes:

Qty	Part Number	Description
1		Pro Flow Muffler
1		Tailpipe Section
1	1045001	O2 Block Off Kit
1	1045021	Tail Pipe Hanger
2	1044027	Bolt, Flange Gaskets
4	8012225	M10 Flanged Lock Nut
4	8012129	M10x40mm Flanged Bolt